

What's New for 2011-2012

- **Consult Migratory Bird Regulations Pamphlet for bag limit changes**

The T. M. Goodwin Unit, also known as the C-54 Retention Area, is part of the Upper St. Johns River Basin Federal Flood Control Project sponsored by the St. Johns River Water Management District and the U. S. Army Corps of Engineers. **Periodically, this area may be subject to flooding during adverse water conditions.**

Please do not discharge firearms at anything other than legal game while on the T.M. Goodwin or Broadmoor Marsh Units. Target practice and random discharge of firearms detract greatly from the hunting experience.

In addition to the regulations printed in this brochure, all state hunting regulations apply.

Your support is appreciated. If you have any questions concerning the T.M. Goodwin or Broadmoor Marsh Units, or waterfowl in general, please contact the Waterfowl Management Area office at (321) 726-2862.

Please visit our website at www.MyFWC.com/duck for other information including updates, check station data and various waterfowl information.

ATTENTION HUNTERS!

Please Report Leg Bands

**Call
1-800-327-BAND**

Please do not litter. Take trash out with you.

*1-888-HUNT-FLORIDA (1-888-486-8356)
Purchase Florida hunting or fishing licenses 24
hours a day with a credit card and a toll-free call.
(A \$3.95 convenience charge will be added.)*

The T.M. Goodwin Unit is a 3,870-acre wetland restoration project in the upper St. Johns River basin. Funding for development of the T.M. Goodwin Unit was provided by the North American Wetlands Conservation Council, Ducks Unlimited (DU), and the Florida Fish and Wildlife Conservation Commission (Commission) on land owned by the St. Johns River Water Management District (District).

The T.M. Goodwin Unit represents the fifth and largest DU MARSH project developed by the Commission in Florida. MARSH is an acronym for Matching Aid to Restore States Habitat. This program was established in 1985 and provides funds which are equally matched by the Commission for the development of wetland projects. Collectively, these funds were used as a match to receive contributions from the North American Wetlands Conservation Council under the auspices of the North American Wetlands Conservation Act (NAWCA). Like DU MARSH, NAWCA provides federal matching funds for cooperative efforts to protect, restore, and enhance wetlands of critical importance to waterfowl and other wetland wildlife. Your support of these programs will allow us to continue to develop new wetland projects throughout Florida providing a variety of wildlife hunting and viewing opportunities.

The Broadmoor Marsh Unit is a 2,400-acre wetland restoration project in the upper St. John's River basin. Funding for development was provided by the Natural Resources Conservation Service through the Wetland Reserve Program (WRP), on land owned by the St. John's River Water Management District. DU constructed the project and the Commission will serve as the lead managing agency.

The objective of the T.M. Goodwin and Broadmoor Marsh Units is to maintain high quality wetland habitat for wintering, migrating, and resident waterfowl, and other wetland wildlife, while providing recreational opportunities to the public. Both Units comprise 3,000 acres of intensively managed impoundments, with the remaining acres being maintained as open marsh habitat. Water level manipulation is the major tool used to manage the area; prescribed burning, mechanical disturbance, and chemical controls also may be used when needed to maintain productive habitat.

This agency and the Department of Interior prohibit discrimination by race, color, nationality, age, sex, or handicap. If you believe you have been discriminated against in any program, activity, or facility of this agency, write to: Florida Fish and Wildlife Conservation Commission, 620 South Meridian, Tallahassee, FL 32399-1600; or to: Office of Human Relation, USFWS, Dept. Of Interior, Washington, D.C. 20240.



**Wildlife Alert
Report Fish and Wildlife
Violations**

REWARD

Call Toll-Free 24 Hr. 1-888-404-FWCC

T. M. Goodwin Waterfowl Management Area

2011-2012 Regulations and Map



**The T.M. Goodwin WMA, including the
Broadmoor Marsh Unit, was developed in
cooperation by**

St. Johns River Water Management District
North American Wetlands Conservation Council
Ducks Unlimited, and
Florida Fish and Wildlife Conservation
Commission

Partnership for Wetland Restoration

An Equal Opportunity Agency

GENERAL REGULATIONS

- General public access is permitted from one hour before sunrise to one hour after sunset on days when hunting is not allowed. Access is restricted to walking, boating (40 HP or less), horseback riding, and bicycling only, except as noted below.
- Vehicle access and parking is permitted on the T.M. Goodwin Unit as indicated by the area map (see back page) on Mondays and Thursdays between 9:00 a.m. and 4:00 p.m., excluding state holidays.
- Vehicle access and parking is permitted on the Broadmoor Marsh Unit as indicated by the area map on Thursdays between 9:00 a.m. and 4:00 p.m., excluding state holidays.
- Airboats (except for alligator harvest permittees), internal combustion engines greater than 40 horsepower, tracked vehicles, motorcycles, and all terrain vehicles are prohibited.
- Public use is prohibited in areas posted as "Closed" or "Restricted." Levees may also be periodically closed to vehicular traffic due to weather, water levels, etc.
- Unleashed dogs other than those used for retrieving waterfowl and snipe are prohibited.
- Construction or use of permanent blinds or structures is prohibited.
- Tampering with or vandalism of water control structures and other facilities and equipment is prohibited.

HUNTING REGULATIONS

- **Legal To Take:** Ducks, geese, and coots **only** during waterfowl season and snipe **only** during specified hunt dates. **Moorhens are permitted during youth hunt only.** Alligators and alligator eggs are permitted pursuant to Rules 68A-25.031 and 68A-25.042, F.A.C. See Migratory Game Bird Regulations for Waterfowl, Geese and Coots for detailed information on bag limits and hunting methods.
- **September Wood Duck/Teal Season Dates:** September 24 and 27.
- **Waterfowl Hunt Dates:** November 19, 22 and 26.
December 10, 13, 17, 20, 24, 27, and 31.
January 3, 7, 10, 14, 17, 21, 24, and 28.
February 4 and February 5 (special youth waterfowl hunt).
- **Snipe Hunt Dates:** February 7, 11, and 14.
- **Shooting Hours:** One-half hour before sunrise until noon.
- Hunters are requested to keep all firearms secure until entering your assigned hunt location.

- Hunters must check in and out at the check station, and check all game taken by 1:00 p.m. each day. **Check station hours are 4:00 a.m. to 1:00 p.m. on waterfowl hunt days and 6:30am until 1:00 p.m. on snipe hunt days.**
- Shooting ducks, geese and coots from levees is prohibited except for internal levees in the T.M. Goodwin Unit reservoir (the area north of levee L-104).
- Steel or other non-toxic shot approved by the U. S. Fish and Wildlife service must be used when hunting ducks, geese, coots, moorhens, and snipe.
- The possession of firearms other than shotguns is prohibited.
- Shotguns capable of holding more than 3 shells are prohibited.
- Hunters may hunt only in assigned areas.
- Vehicle access and parking for hunting on the T.M. Goodwin Unit is restricted to the check station located at the southeast corner and the pump station located at the northwest corner. Only 1 vehicle per permit will be permitted to park at the pump station.
- Vehicle access and parking for hunting on the Broadmoor Marsh Unit is restricted to areas marked with * on levees L-74 NORTH, L-1, L-3, L-5, L-6, L-8, L-11 and L-15 unless the levee is posted as closed.
- **License Requirements:** Unless exempted by law, hunters must possess a valid Florida hunting license, a Florida waterfowl permit (also known as Florida duck stamp), a federal duck stamp, a migratory bird permit, and a wildlife management area permit. Consult Migratory Game Bird Regulations for Waterfowl and Coots for detailed information on exemptions. Hunting licenses, Florida waterfowl permits, and migratory bird permits are available at county tax collector offices or their subagents. Federal duck stamps are available at most U.S. Post Offices or online at www.duckstamp.com, they can also be found at some sporting goods stores and tax collectors offices.
- **Waterfowl Hunter Quota:** No more than 31 permits (maximum of 4 hunters per permit) will be issued each hunt day; 16 permits for the T.M. Goodwin Unit, 1 permit for the mobility-impaired blind on Goodwin Lake and 14 permits for the Broadmoor Marsh Unit.
- **Snipe Hunter Quota:** The number of permits (maximum of 4 hunters per permit) issued on a first-come first-served basis each hunt day shall be determined by management area staff one week prior to the start of snipe hunting on the area. The number of permits will be based on the quantity of suitable habitat available that can be expected to provide a satisfying hunting experience provided there shall be no less than 50 acres available per permit. Snipe hunters shall select their preferred hunt location on a first-come first-served basis the

RESERVATION PROCESS FOR DUCK HUNTING

- Waterfowl Quota Hunt permits, including the Youth Hunt, will be issued through the Total Licensing System (TLS).

Hunt Choice Application Periods

Period 1: October 14-23.
Period 2: November 4-13.
Period 3: December 9-18.

Youth Hunts: January 5-16.

- To apply for a permit during the designated application periods, other than the mobility-impaired permit, you must complete the Quota Hunt Worksheet and present it to any **tax collector's office OR you may apply online at www1.fl.wildlifelicenses.com/start.php** and choose "Limited Entry/Quota Permits and Applications".
- Worksheets, including a separate worksheet for the Youth Hunt, will be available online at www.myfwc.com/license/limited-entry-hunts/, select T.M. Goodwin and scroll to the bottom of the page they will be at the T.M. Goodwin office.
- The selection order for hunt zones will be based on the order which permits were issued. That is, the first person to receive a permit will have the first selection of hunt zone the morning of the hunt.
- Hunters requesting a **permit for the Persons with Disabilities (PWD) blind** shall call the T.M Goodwin office at (321-726-2862) beginning at 10:00 a.m. on the Wednesday prior to the Saturday or Tuesday they wish to hunt. This permit will NOT be issued through the TLS system. **Only hunters with a PWD Duck Blind Qualifying Card issued by the commission may apply for a permit to use the mobility-impaired blind.**
- All permit holders must check in at the check station no later than **4:30 a.m.** the morning of the hunt; permits not claimed by this time will be forfeited. Hunters without a permit (walk-in hunters) may enter the area on a first-come, first-served basis at the check station the morning of each hunt until the daily permit quota is reached. Hunters without a permit will select their preferred hunt location on a first-come first-served basis from any unclaimed or unassigned hunt locations.
- For detailed instructions on the reservation process **refer to the Quota Hunt Worksheet** or call the T.M. Goodwin office at **(321) 726-2862**.

T.M. Goodwin Waterfowl

Management Area

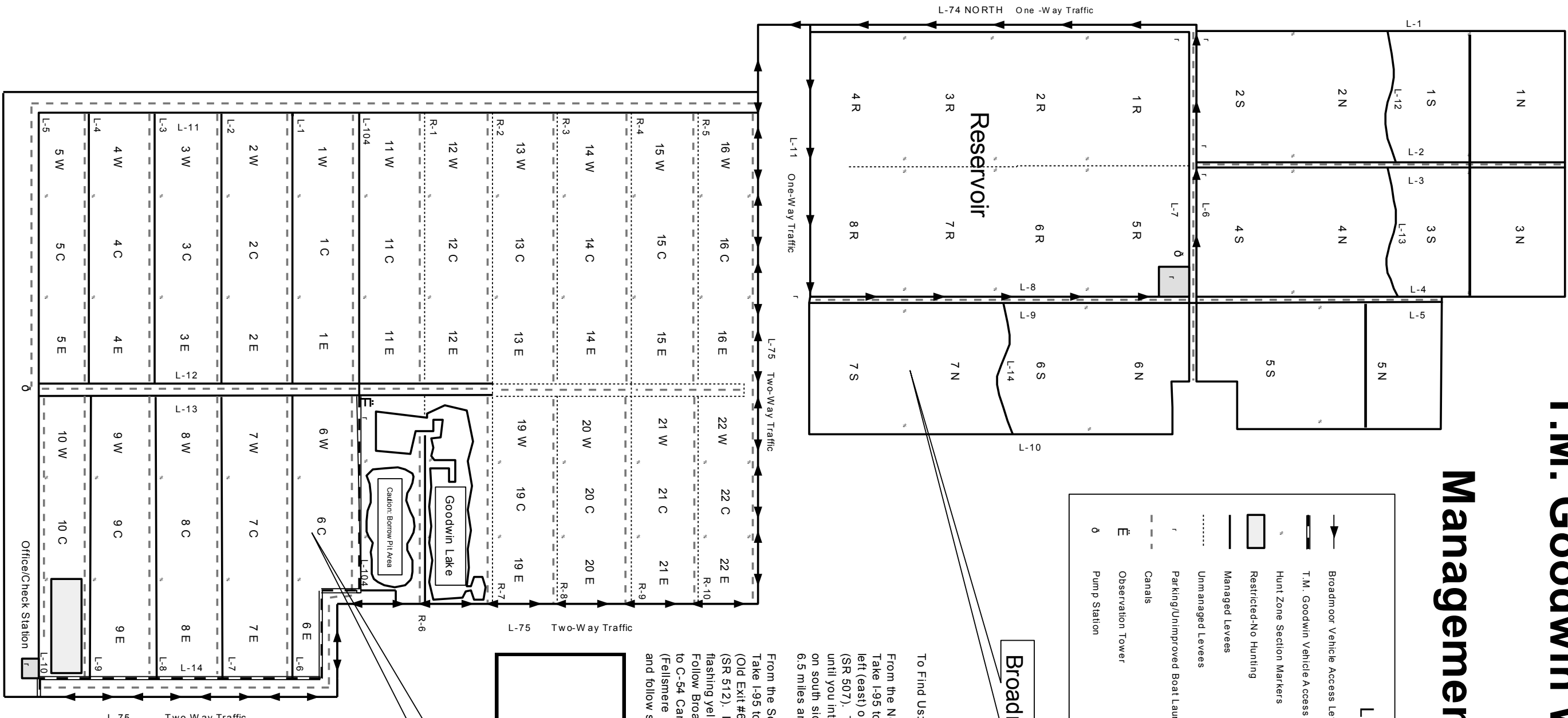

Legend

- Broadmoor Vehicle Access Levees, Thursdays 9:00 AM to 4:00 PM
- T.M. Goodwin Vehicle Access Levees, Mondays and Thursdays 9:00 AM to 4:00 PM
- Hunt Zone Section Markers
- Restricted-No Hunting
- Managed Levees
- Unmanaged Levees
- Parking/Unimproved Boat Launch Areas
- Canals
- Observation Tower
- Pump Station

Broadmoor Marsh Unit

To Find Us:

From the North:
 Take I-95 to Malabar, Exit #173 (Old Exit #70). Turn left (east) on Malabar Road to Babcock Street (SR 507). Turn right (south) for about 1.5 miles until you intersect the C-54 Canal. Turn right (west) on south side of canal (Fellsmere Grade) for about 6.5 miles and follow signs to the T.M. Goodwin WMA.

From the South:
 Take I-95 to Sebastian/Fellsmere, Exit #156 (Old Exit #69) and turn left (west) on Fellsmere Road (SR 512). In Fellsmere, turn right (north) at the second flashing yellow light on Broadway Street (SR 507). Follow Broadway Street, which turns into SR 507, to C-54 Canal and turn left (west) on south side of canal (Fellsmere Grade). Continue west for about 6.5 miles and follow signs to the T.M. Goodwin WMA.

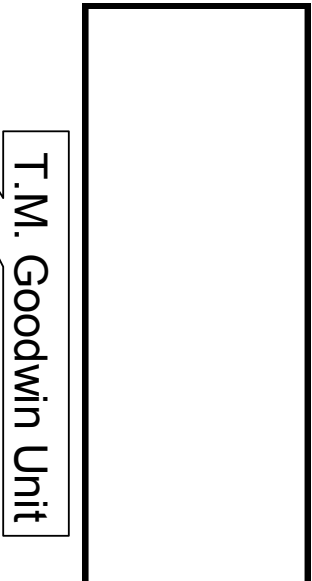

Note: All T.M. Goodwin and Broadmoor Marsh hunters must check in/out at the Check Station.

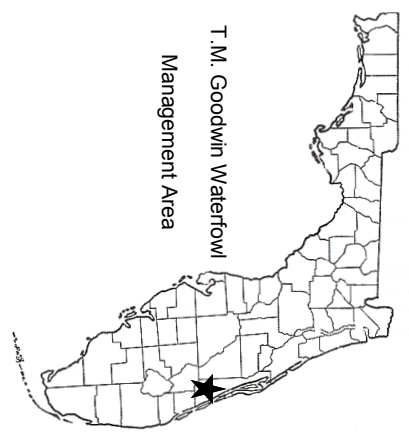

< Entrance